

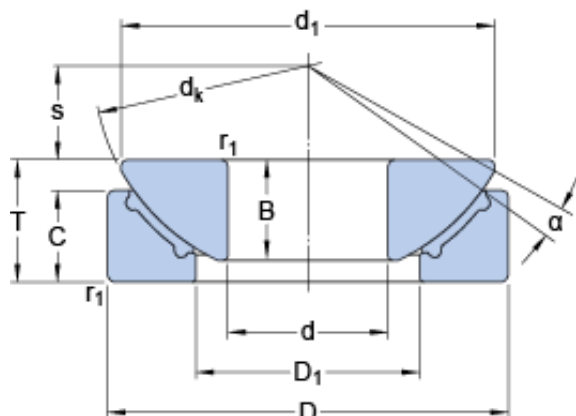

LINK BELT BEARING LTD



70 mm x 160 mm x 42 mm SKF GX 70 F
JAPAN Bearing 70*160*42

Bearing No. GX 70 F

GX 70 F Bearing 2D drawings and 3D CAD models

Size	70x160x50 mm
Bore Diameter	70 mm
Outer Diameter	160 mm
Width	50 mm
d	70 mm
D	160 mm
T	50 mm
	5 °
dk	176 mm
d ₁	153 mm
D ₁	94.5 mm
B	42 mm
C	36.5 mm
r ₁ - min.	1 mm
s	35 mm
d _a - min.	121 mm
D _a - max.	125 mm
r _a - max.	1 mm
Basic dynamic load rating - C	475 kN
Basic static load rating - C ₀	750 kN
Specific factor dynamic load - K	50 N/mm ²
Specific factor static load - K ₀	80 N/mm ²
Constant - K _M	670



LINK BELT BEARING LTD

Category	Spherical Plain Bearings - Thrust
Inventory	0.0
Manufacturer Name	SKF
Minimum Buy Quantity	N/A
Weight / Kilogram	5.41
Product Group	B04264
Rolling Element	Spherical Plain
Self Aligning	Yes
Material - Outer Member	Steel
Material - Ball	Steel
Material - Liner	Plastic Teflon
Enclosure	Open
Relubricatable	No
Other Features	Single Direction Self Lubricating Maintenance Free
Long Description	70MM Bore; 160MM Housing Outside Diameter; 50MM Overall Width; Spherical Plain; Self Aligning; Steel Outer Member; Steel Ball; Plastic Teflon Liner; 153MM Ball Outside Diam; 36.5MM Housing Width; No
Inch - Metric	Metric
Category	Plain Bearings Spherical Thrust
UNSPSC	31171515
Harmonized Tariff Code	8483.30.80.70
Noun	Bearing
Keyword 3	Spherical
Keyword String	Plain Thrust Spherical
Manufacturer URL	http://www.skf.com
Manufacturer Item Number	GX 70 F



LINK BELT BEARING LTD

Weight / LBS	11.905
Housing Width	1.437 Inch 36.5 Millimeter
Bore	2.756 Inch 70 Millimeter
Housing Outside Diameter	6.299 Inch 160 Millimeter
Ball Outside Diameter	6.024 Inch 153 Millimeter
Overall Width	1.969 Inch 50 Millimeter
bore diameter:	70 mm
inner ring material:	Steel
outside diameter:	160 mm
outer ring width:	36.5 mm
misalignment angle:	5 °
race material:	PTFE Composite
inner ring width:	50 mm
overall width:	50 mm
bearing type:	Thrust
radial static load capacity:	750 kN
lubrication type:	Maintenance Free/Self-Lubricating
radial dynamic load capacity:	475 kN
closure type:	Open
operating temperature range:	-40 to +75 ° C ° F
outer ring material:	Steel
manufacturer upc number:	7316577002440
	3.5 °
d_k	176 mm
d_1	153 mm
D_1	94.5 mm
r_1 min.	1 mm
d_a min.	121 mm
D_a max.	125 mm
r_a max.	1 mm



LINK BELT BEARING LTD

Basic dynamic load rating - axial direction C	475 kN
Basic static load rating - axial direction C_0	750 kN
Specific dynamic load factor K	50 N/mm ²
Specific static load factor K_0	80 N/mm ²
Material constant K_M	670
Mass plain bearing	5.4 kg