

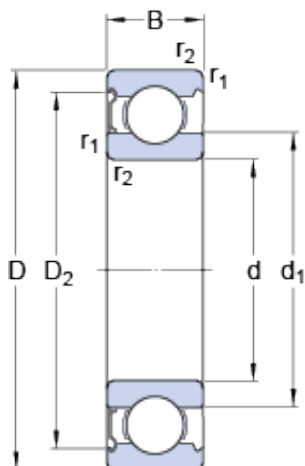

## LINK BELT BEARING LTD



60 mm x 130 mm x 31 mm SKF 6312-Z  
GERMANY Bearing 60\*130\*31

Bearing No. 6312-Z

6312-Z Bearing 2D drawings and 3D CAD models

Size	130x60x31 mm
Bore Diameter	130 mm
Outer Diameter	60 mm
Width	31 mm
d	60 mm
D	130 mm
B	31 mm
d <sub>1</sub>	81.86 mm
D <sub>2</sub>	112.2 mm
r <sub>1,2</sub> - min.	2.1 mm
d <sub>a</sub> - min.	72 mm
d <sub>a</sub> - max.	81.8 mm
D <sub>a</sub> - max.	118 mm
r <sub>a</sub> - max.	2 mm
Basic dynamic load rating - C	85.2 kN
Basic static load rating - C <sub>0</sub>	52 kN
Fatigue load limit - P <sub>u</sub>	2.2 kN
Reference speed	11000 r/min
Limiting speed	7000 r/min
Calculation factor - k <sub>r</sub>	0.03
Calculation factor - f <sub>0</sub>	13.1
Category	Single Row Ball Bearings
Inventory	0.0
Manufacturer Name	SKF



## LINK BELT BEARING LTD

Minimum Buy Quantity	N/A
Weight / Kilogram	1.78
Product Group	B00308
Enclosure	1 Metal Shield
Precision Class	ABEC 1   ISO P0
Maximum Capacity / Filling Slot	No
Rolling Element	Ball Bearing
Snap Ring	No
Internal Special Features	No
Cage Material	Steel
Internal Clearance	C0-Medium
Inch - Metric	Metric
Long Description	60MM Bore; 130MM Outside Diameter; 31MM Outer Race Diameter; 1 Metal Shield; Ball Bearing; ABEC 1   ISO P0; No Filling Slot; No Snap Ring; No Internal Special Features
Category	Single Row Ball Bearing
UNSPSC	31171504
Harmonized Tariff Code	8482.10.50.68
Noun	Bearing
Keyword String	Ball
Manufacturer URL	<a href="http://www.skf.com">http://www.skf.com</a>
Manufacturer Item Number	6312-Z
Weight / LBS	3.92
Bore	2.362 Inch   60 Millimeter
Outer Race Width	1.22 Inch   31 Millimeter
Outside Diameter	5.118 Inch   130 Millimeter
d <sub>1</sub>	81.86 mm
D <sub>2</sub>	112.2 mm
r <sub>1,2</sub> min.	2.1 mm



## LINK BELT BEARING LTD

$d_a$ min.	72 mm
$d_a$ max.	81.8 mm
$D_a$ max.	118 mm
$r_a$ max.	2 mm
Basic dynamic load rating C	85.2 kN
Basic static load rating $C_0$	52 kN
Fatigue load limit $P_u$	2.2 kN
Calculation factor $k_r$	0.03
Calculation factor $f_0$	13.1
Mass bearing	1.74 kg